

**Office Use Only**

VicSmart?

☐ YES☐ NO

Specify class of VicSmart application:

Application No.:

Date Lodged: / /

## Application for a Planning Permit

If you need help to complete this form, read **MORE INFORMATION** at the back of this form.

**Any material submitted with this application, including plans and personal information, will be made available for public viewing, including electronically, and copies may be made for interested parties for the purpose of enabling consideration and review as part of a planning process under the *Planning and Environment Act 1987*. If you have any concerns, please contact Council's planning department.**

**Questions marked with an asterisk (\*) must be completed.**

**If the space provided on the form is insufficient, attach a separate sheet.**

**Click for further information.**

[Clear Form](#)

### Application Type

Is this a VicSmart application?\*

☒ No ☐ Yes

If yes, please specify which

VicSmart class or classes:.....

**If the application falls into one of the classes listed under Clause 92 or the schedule to Clause 94, it is a VicSmart application.**

### Pre-application Meeting

Has there been a pre-application meeting with a Council planning officer?

☒ No ☐ Yes

If 'Yes', with whom?:

Date:

day / month / year

### The Land

Address of the land. Complete the Street Address and one of the Formal Land Descriptions.

**Street Address \***

Unit No.:

St. No.: 108

St. Name: Sycamore Street

Suburb/Locality: Hoppers Crossing

Postcode: 3029

**Formal Land Description \***

Complete either A or B.

**This information can be found on the certificate of title.**

If this application relates to more than one address, attach a separate sheet setting out any additional property details.

A Lot No.: 173

☐ Lodged Plan☐ Title Plan☐ Plan of Subdivision

No.: LP144602

OR

B Crown Allotment No.:

Section No.:

Parish/Township Name:

## The Proposal

**A** You must give full details of your proposal and attach the information required to assess the application. Insufficient or unclear information will delay your application.

**1** For what use, development or other matter do you require a permit? \*

Construction of one (1) single-storey residence to be built at the rear of the existing residence with a proposed garage servicing the existing residence and proposed vehicle crossover

**2** Provide additional information about the proposal, including: plans and elevations; any information required by the planning scheme, requested by Council or outlined in a Council planning permit checklist; and if required, a description of the likely effect of the proposal.

**1** Estimated cost of any development for which the permit is required \*

Cost \$ 200000

**A** You may be required to verify this estimate. Insert '0' if no development is proposed.

If the application is for land within metropolitan Melbourne (as defined in section 3 of the Planning and Environment Act 1967) and the estimated cost of the development exceeds \$1 million (adjusted annually by CPI) the Metropolitan Planning Levy must be paid to the State Revenue Office and a current levy certificate must be submitted with the application. Visit [www.sro.vic.gov.au](http://www.sro.vic.gov.au) for information.

## Existing Conditions

Describe how the land is used and developed now \*

For example, vacant, three dwellings, medical centre with two practitioners, licensed restaurant with 80 seats, grazing.

There is a single-storey residence to remain on-site

**2** Provide a plan of the existing conditions. Photos are also helpful.

## Title Information

Encumbrances on title \*

Does the proposal breach, in any way, an encumbrance on title such as a restrictive covenant, section 173 agreement or other obligation such as an easement or building envelope?

- ☐ Yes (if 'yes' contact Council for advice on how to proceed before continuing with this application.)
- ☐ No
- ☐ Not applicable (no such encumbrance applies).

**2** Provide a full, current copy of the title for each individual parcel of land forming the subject site. The title includes: the covering 'register search statement', the title diagram and the associated title documents, known as 'instruments', for example, restrictive covenants.

## Applicant and Owner Details 11

Provide details of the applicant and the owner of the land.

### Applicant \*

The person who wants the permit.

Please provide at least one contact phone number \*

Where the preferred contact person for the application is different from the applicant, provide the details of that person.

### Owner \*

The person or organisation who owns the land

Where the owner is different from the applicant, provide the details of that person or organisation.

Name:		
Title: Mr	First Name: ELIAS	Surname: TANAJOUS
Organisation (if applicable):		
Postal Address:		
Unit No.: 6	St. No.: 49/69	St. Name: Royal Crescent
Suburb/Locality: Hillside	State: vic	Postcode: 3037

### Contact information for applicant OR contact person below

Business phone: 03 9310 8800	Email: info@xbdg.com.au
Mobile phone:	Fax:

### Contact person's details\*

Same as applicant ☐

Name:		
Title:	First Name:	Surname:
Organisation (if applicable): Xpress Building Design		
Postal Address:		
Unit No.: 2	St. No.: 79	St. Name: Main Road West
Suburb/Locality: St Albans	State: VIC	Postcode: 3021

Same as applicant ☒

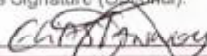
Name:		
Title: Mr	First Name: ELIAS	Surname: TANAJOUS
Organisation (if applicable):		
Postal Address:		
Unit No.:	St. No.:	St. Name:
Suburb/Locality:	State:	Postcode:
Owner's Signature (Optional): 		Date: day / month / year

## Information requirements

Is the required information provided?

Contact Council's planning department to discuss the specific requirements for this application and obtain a planning permit checklist.

☒ Yes ☐ No

## Declaration 11

This form must be signed by the applicant \*

 Remember it is against the law to provide false or misleading information, which could result in a heavy fine and cancellation of the permit.

I declare that I am the applicant, and that all the information in this application is true and correct, and the owner (if not myself) has been notified of the permit application.

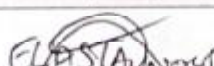
Signature: 	Date: 1/12/2020 day / month / year
--	---------------------------------------

## REGISTER SEARCH STATEMENT (Title Search) Transfer of Land Act 1958

Page 1 of 1

VOLUME 09573 FOLIO 436

Security no : 124086955389C  
Produced 04/12/2020 10:48 AM

### LAND DESCRIPTION

Lot 173 on Plan of Subdivision 144602.

PARENT TITLES :

Volume 09425 Folio 322      Volume 09425 Folio 325

Created by instrument LP144602 03/10/1984

### REGISTERED PROPRIETOR

Estate Fee Simple

Sole Proprietor

ELIAS TANNOUS of 7 SOVEREIGN WAY HILLSIDE VIC 3037  
AR324549V 07/08/2018

### ENCUMBRANCES, CAVEATS AND NOTICES

Any encumbrances created by Section 98 Transfer of Land Act 1958 or Section 24 Subdivision Act 1988 and any other encumbrances shown or entered on the plan or imaged folio set out under DIAGRAM LOCATION below.

### DIAGRAM LOCATION

SEE LP144602 FOR FURTHER DETAILS AND BOUNDARIES

### ACTIVITY IN THE LAST 125 DAYS

NIL

-----END OF REGISTER SEARCH STATEMENT-----

Additional information: (not part of the Register Search Statement)

Street Address: 108 SYCAMORE STREET HOPPERS CROSSING VIC 3029

DOCUMENT END

**WYNDHAM CITY COUNCIL**  
**Town Planning**  
**Advertised Documents**

**Plan: 4 of 6**

# Imaged Document Cover Sheet

The document following this cover sheet is an imaged document supplied by LANDATA®, Land Use Victoria.

Document Type	<b>Plan</b>
Document Identification	<b>LP144602</b>
Number of Pages (excluding this cover sheet)	<b>1</b>
Document Assembled	<b>12/09/2018 14:57</b>

**Copyright and disclaimer notice:**

© State of Victoria. This publication is copyright. No part may be reproduced by any process except in accordance with the provisions of the Copyright Act and for the purposes of Section 32 of the Sale of Land Act 1962 or pursuant to a written agreement. The information is only valid at the time and in the form obtained from the LANDATA® System. The State of Victoria accepts no responsibility for any subsequent release, publication or reproduction of the information.

The document is invalid if this cover sheet is removed or altered.

**WYNDHAM CITY COUNCIL**  
**Town Planning**  
**Advertised Documents**

**Plan: 5 of 6**

**LP144602**  
**EDITION 1**  
 APPROVED 17/9/84

**PLAN OF SUBDIVISION OF:  
 PART OF CROWN  
 ALLOTMENT 2 SECTION B**

**PARISH: TARNEIT**  
**COUNTY: BOURKE**

**SCALE**  
 80 40 0 80 160  
**LENGTHS ARE IN METRES**

**APPROPRIATIONS**

BROWN :- CARRIAGEWAY, DRAINAGE  
 & SEWERAGE.  
 BLUE :- DRAINAGE & SEWERAGE.

**ENCUMBRANCES & OTHER NOTATIONS**

YELLOW :- DRAINAGE & SEWERAGE  
 EASEMENT VIDE L.P. 130483.  
 LOT Nos. 1 TO 168 (BOTH INCLUSIVE) HAVE  
 BEEN OMITTED FROM THIS PLAN.  
 DIMENSIONS OF LOT J ARE NOT THE RESULT  
 OF THIS SURVEY.

DEPTH LIMITATION: 15.24m

VOL. 9425 FOL 322  
 VOL. 9425 FOL 325

C.A. B SEC. 11

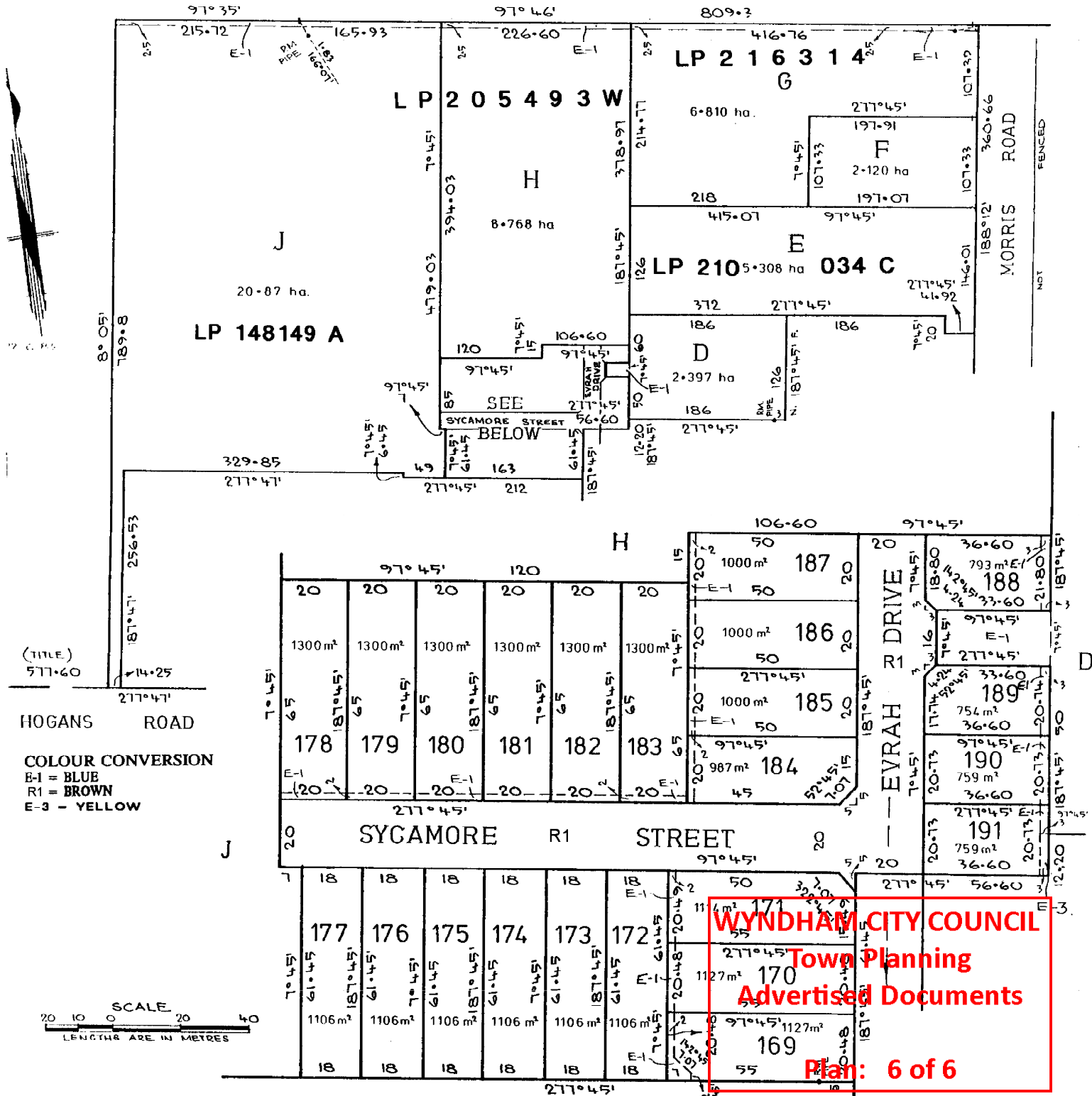

**WYNDHAM CITY COUNCIL**  
 Town Planning  
 Advertised Documents

Plan: 6 of 6