

## REGISTER SEARCH STATEMENT (Title Search) Transfer of Land Act 1958

Page 1 of 1

VOLUME 10449 FOLIO 993

Security no : 124100332974X  
Produced 15/09/2022 04:34 PM

### LAND DESCRIPTION

Lot 7 on Plan of Subdivision 417056X.  
PARENT TITLE Volume 10369 Folio 676  
Created by instrument PS417056X 09/06/1999

### REGISTERED PROPRIETOR

Estate Fee Simple  
Sole Proprietor

### ENCUMBRANCES, CAVEATS AND NOTICES

Any encumbrances created by Section 98 Transfer of Land Act 1958 or Section 24 Subdivision Act 1988 and any other encumbrances shown or entered on the plan set out under DIAGRAM LOCATION below.

### DIAGRAM LOCATION

SEE PS417056X FOR FURTHER DETAILS AND BOUNDARIES

### ACTIVITY IN THE LAST 125 DAYS

NIL

-----END OF REGISTER SEARCH STATEMENT-----

Additional information: (not part of the Register Search Statement)

Street Address: UNIT 7 70 WATTON STREET WERRIBEE VIC 3030

### OWNERS CORPORATIONS

The land in this folio is affected by  
OWNERS CORPORATION PLAN NO. PS417056X

DOCUMENT END

**WYNDHAM CITY COUNCIL**  
**Town Planning**  
**Advertised Documents**

**Plan: 1 of 5**

# Imaged Document Cover Sheet

The document following this cover sheet is an imaged document supplied by LANDATA®, Secure Electronic Registries Victoria.

Document Type	<b>Plan</b>
Document Identification	<b>PS417056X</b>
Number of Pages (excluding this cover sheet)	<b>3</b>
Document Assembled	<b>23/11/2022 12:22</b>

**Copyright and disclaimer notice:**

© State of Victoria. This publication is copyright. No part may be reproduced by any process except in accordance with the provisions of the Copyright Act 1968 (Cth) and for the purposes of Section 32 of the Sale of Land Act 1962 or pursuant to a written agreement. The information is only valid at the time and in the form obtained from the LANDATA® System. None of the State of Victoria, LANDATA®, Secure Electronic Registries Victoria Pty Ltd (ABN 86 627 986 396) as trustee for the Secure Electronic Registries Victoria Trust (ABN 83 206 746 897) accept responsibility for any subsequent release, publication or reproduction of the information.

The document is invalid if this cover sheet is removed or altered.



PLAN OF SUBDIVISION		Stage No. _____	Plan Number <b>PS 417056 X</b>
---------------------	--	-----------------	-----------------------------------

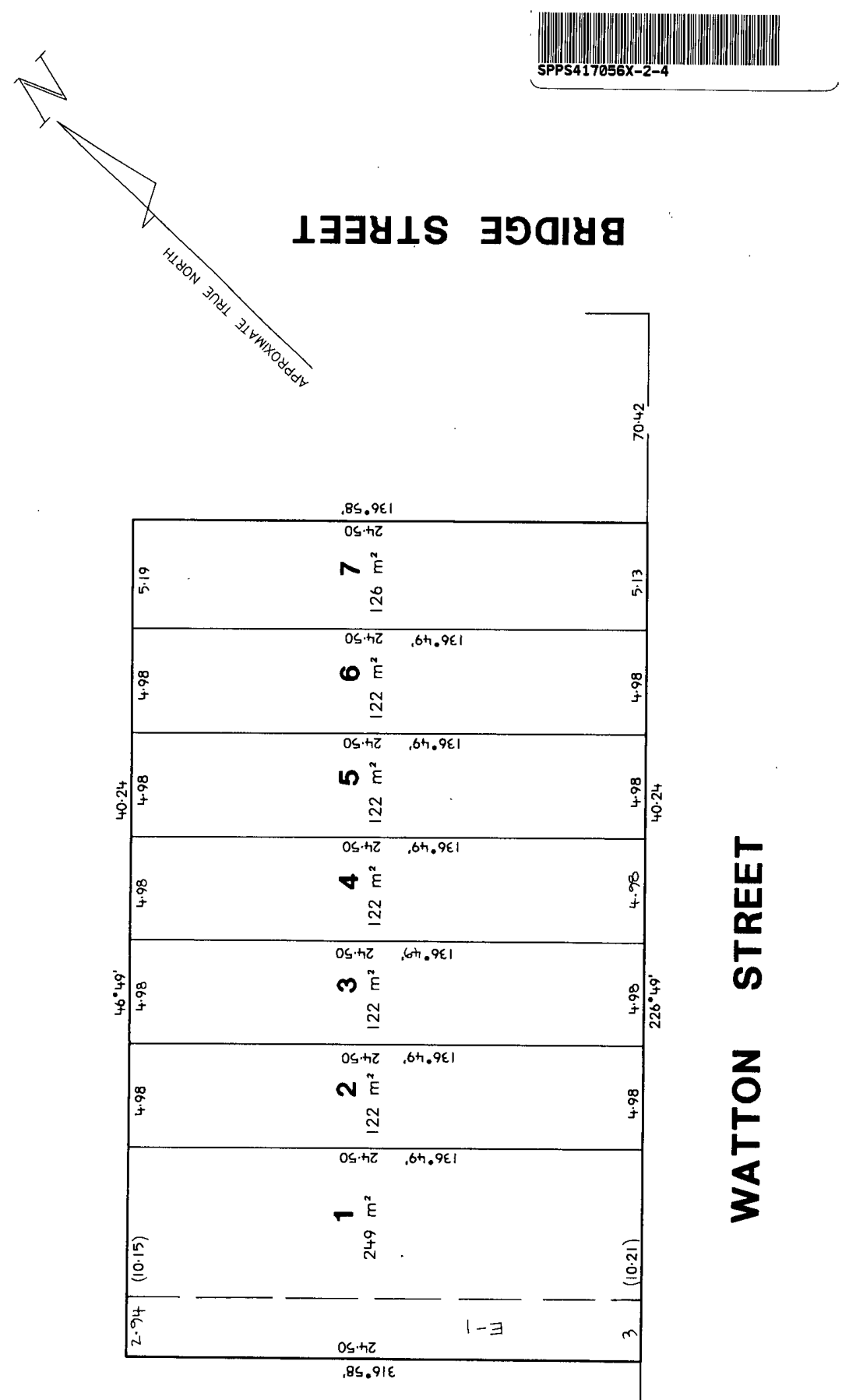

**WYNDHAM CITY COUNCIL**  
Town Planning  
Advertised Documents  
Plan: 4 of 5

<b>AMS CONSULTING LAND SURVEYORS</b> SUITE 10, 322 MOUNTAIN HIGHWAY, WANTIRNA, 3162. BN. 720 8500 FAX. 720 8500 MOB. (0181) 381193 ACN.056 815 983		ORIGINAL SCALE SHEET SIZE A3 1:200	SCALE 2 0 4 8 LENGTHS ARE IN METRES	LICENSED SURVEYOR (PRINT) <u>ANDREW MALCOLM SMITH</u> SIGNATURE _____ DATE ____/____/____ REF <b>1188</b> VERSION <b>2-(9C.188)</b> 8/10/98	Sheet 2 of 3 Sheets COUNCIL DELEGATE SIGNATURE _____ DATE ____/____/____
---	--	---	---	--	--

PS417056X

FOR CURRENT BODY CORPORATE DETAILS  
SEE BODY CORPORATE SEARCH REPORT